



10/24-30 Lamington Terrace Nambour QLD

2  1  1 

Within easy and convenient access to towns' facilities, shopping precincts and public transport, this fantastic unit is located in a small, well laid out complex.

The living area is light and airy, open plan with adjacent well equipped kitchen with good storage. Sliding doors access to a generous deck area with a pleasant leafy outlook.

Currently rented for \$300 per week with a great tenant in place who would be agreeable to stay on.

Please call us for your inspection by appointment.

Price : \$ 334,000

View : <https://www.keylinerealty.com/sale/qld/sunshine-coast/nambour/residential/unit/6330181>



Paul Skelton
07 5441 2511



Steven Clay
0754412511



UPPER FLOOR

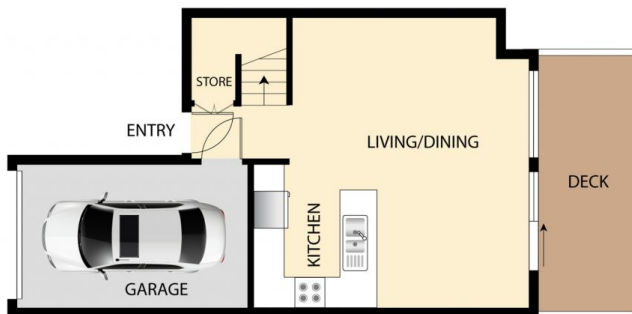

GROUND FLOOR

2 BED 1 BATH 1 CAR

10/24 Lamington Tce, Nambour

Floor plan is for illustrative purposes only. Any dimensions are approximate. All information gathered here from source we believe reliable. However we cannot guarantee its accuracy and interested persons should make their own enquiries to determine to your satisfaction as to the suitability of the property for your space requirements. This floor plan produced by Step Inside property Imaging ©Copyright This image may not be used or reproduced in whole or part with out written permission

STEP INSIDE
PROPERTY IMAGING