



## 12 Crescent Drive Nambour QLD

2  1  2 

The owners of this sweet home have substantially renovated and extended with a focus on quality and beauty, whilst working towards a degree of self sufficiency.

North facing and sitting on an elevated 703m2 block with glorious hinterland views, the position is enviable. Convenient street parking on a wide street, complimented by generous verges, adds to the single carport accommodation.

Inside you are met with polished timber floors and open plan living that overlooks nature at every turn. With 2 generous bedrooms, both with built in robes and a light filled sleepout currently used as an office, the home has surprising little nooks. Oh and don't forget the fireplace, perfectly positioned central to the living rooms.

**Price** : \$ 780,000  
**Land Size** : 703 sqm  
**View** : <https://www.keylinerealty.com/sale/qld/sunshine-coast/nambour/residential/house/7944650>



**Andrew Hicks**  
07 5441 2511



**Nicky Ellem**  
07 5441 2511



# 12 Crescent Drive Nambour

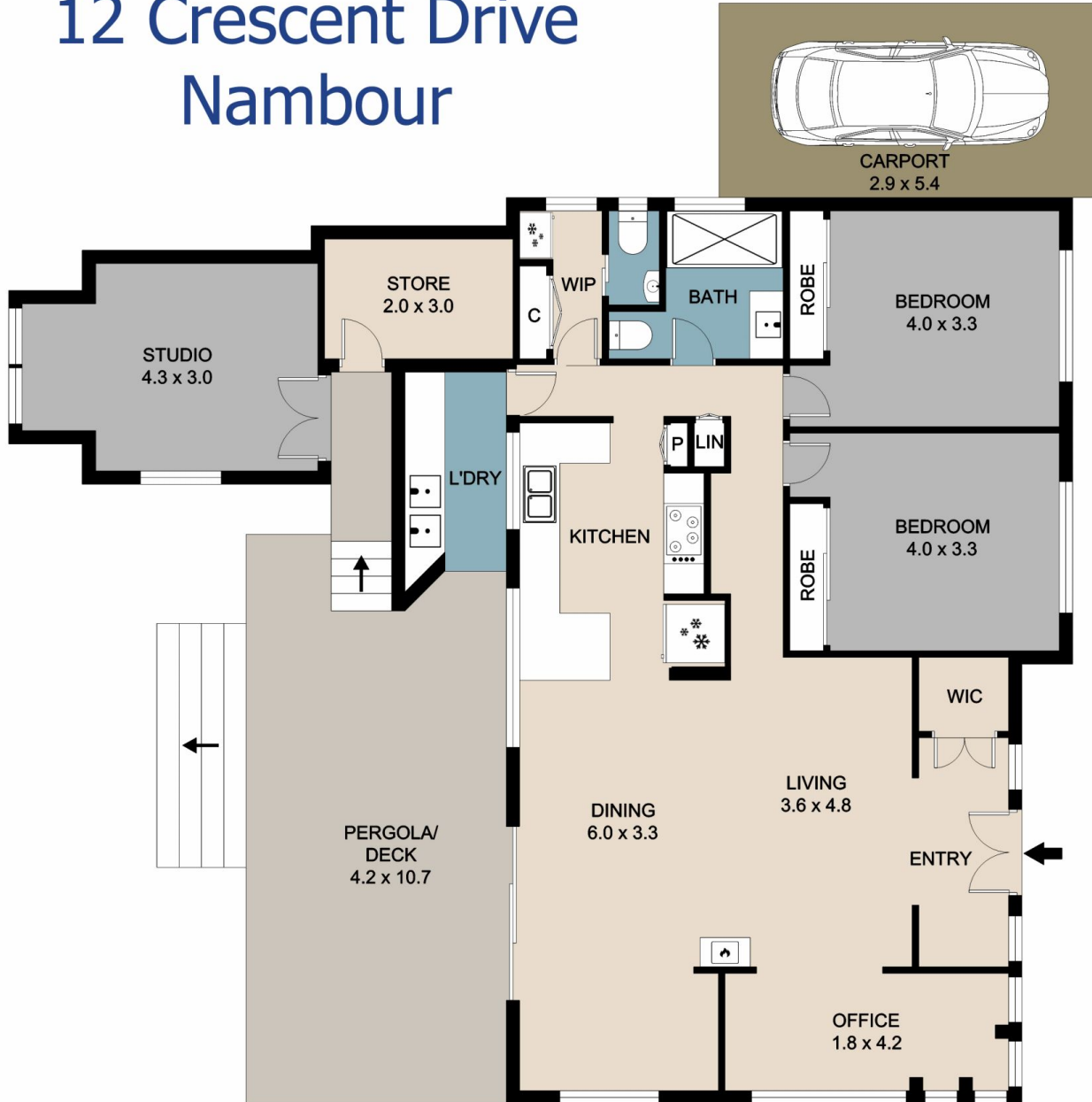

This floor/site plan is conceptual only, it is provided for illustrative purposes and should not be relied upon. We make no guarantee as to the accuracy of this plan, all interested parties should make and rely on their own enquiries in determining the accuracy and information contained on this floor/site plan.